

## 6B 塑料外壳 Plastic Hoods &amp; Housings

## 防护等级 Degree of protection : IP65

## 上壳 侧出线 高结构 Hoods, side entry, high construction



螺纹 Thread	型号 Type	订货号 Part Number
M25	H6B.P-SEH-4B-M25	19300060110
M32	H6B.P-SEH-4B-M32	19300060111

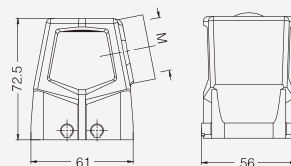

## 上壳 顶出线 高结构 Hoods, top entry, high construction



螺纹 Thread	型号 Type	订货号 Part Number
M25	H6B.P-TEH-4B-M25	19300060120
M32	H6B.P-TEH-4B-M32	19300060121

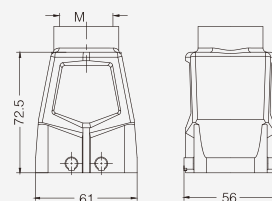

## 不封底下壳 Housings, bulkhead mounting



螺纹 Thread	型号 Type	订货号 Part Number
---	H6B.P-BK-2L	09300060300

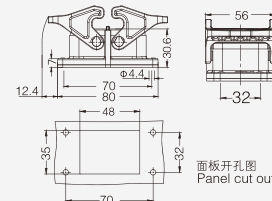

## 封底下壳 高结构 Housings, surface mounting, high construction



螺纹 Thread	型号 Type	订货号 Part Number
M25	H6B.P-SFH-2L-M25	19300060131
2M25	H6B.P-SFH-2L-2M25	19300060135
M32	H6B.P-SFH-2L-M32	19300060132
2M32	H6B.P-SFH-2L-2M32	19300060136

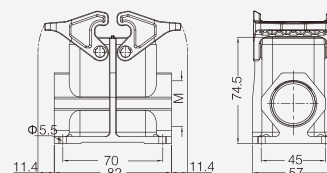

## 防护盖 Protection covers



螺纹 Thread	型号 Type	订货号 Part Number
---	H6B.P-CV-4B/2	09300060140

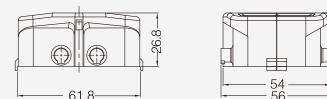

## 防护盖 Protection covers



螺纹 Thread	型号 Type	订货号 Part Number
---	H6B.P-CV-2L/1	09300060145

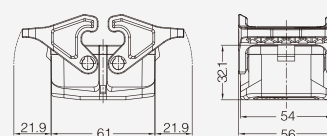

## 6B 金属外壳 Metal Hoods &amp; Housings

## 防护等级 Degree of protection : IP65

## 上壳 侧出线 Hoods, side entry



螺纹 Thread	型号 Type	订货号 Part Number
M20	H6B-SE-2B-M20	19300061540
M25	H6B-SE-2B-M25	19300061541
PG13.5	H6B-SE-2B-PG13.5	09300061540
PG16	H6B-SE-2B-PG16	09300061541

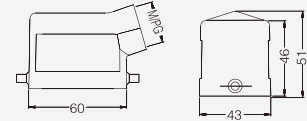

## 上壳 侧出线 高结构 Hoods, side entry, high construction



螺纹 Thread	型号 Type	订货号 Part Number
M25	H6B-SEH-2B-M25	19300060546
M32	H6B-SEH-2B-M32	19300060547
PG21	H6B-SEH-2B-PG21	09300060542
PG29	H6B-SEH-2B-PG29	09300060543

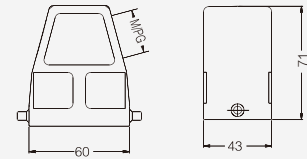

## 上壳 顶出线 Hoods, top entry

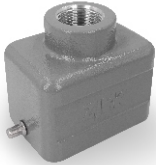

螺纹 Thread	型号 Type	订货号 Part Number
M20	H6B-TE-2B-M20	19300061440
M25	H6B-TE-2B-M25	19300061441
PG13.5	H6B-TE-2B-PG13.5	09300061440
PG16	H6B-TE-2B-PG16	09300061441

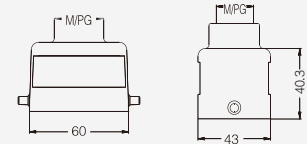

## 上壳 顶出线 高结构 Hoods, top entry, high construction



螺纹 Thread	型号 Type	订货号 Part Number
M20	H6B-TEH-2B-M20	19300060445
M25	H6B-TEH-2B-M25	19300060446
M32	H6B-TEH-2B-M32	19300060447
PG16	H6B-TEH-2B-PG16	09300060441
PG21	H6B-TEH-2B-PG21	09300060442
PG29	H6B-TEH-2B-PG29	09300060443

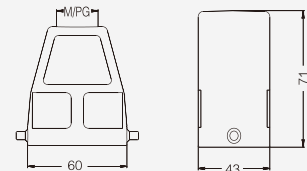

我可提供顶部、侧面同时出线的非标品, 详见P15-04  
We can provide non-standard products with both top&side entry, see P15-04

## 飞线下壳 Housings, cable to cable



螺纹 Thread	型号 Type	订货号 Part Number
M20	H6B-CCT-1L-M20	19300061750
PG13.5	H6B-CCT-1L-PG13.5	09300061750
PG16	H6B-CCT-1L-PG16	09300061751

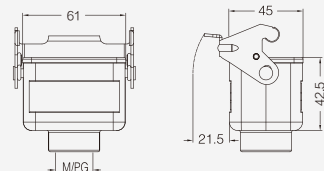

## 飞线下壳 高结构 Housings, cable to cable, high construction



螺纹 Thread	型号 Type	订货号 Part Number
M25	H6B-CCTH-1L-M25	19300060756
PG21	H6B-CCTH-1L-PG21	09300060752
PG29	H6B-CCTH-1L-PG29	09300060753

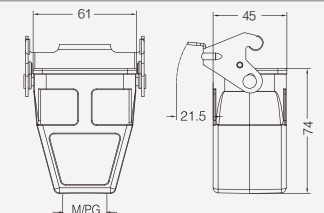



## 6B 金属外壳 Metal Hoods & Housings

防护等级 Degree of protection : IP65

不封底下壳 Housings, bulkhead mounting



螺纹 Thread	型号 Type	订货号 Part Number
---	H6B-BK-1L	09300060301
	带塑料盖 With plastic cover	
---	H6B-BK-1L-CV	09300060302
	带金属料盖 With metal cover	
---	H6B-BK-1L-MCV	09300060318

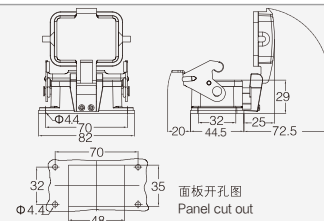

封底下壳 Housings, surface mounting



螺纹 Thread	型号 Type	订货号 Part Number
M20	6B-SF-1L-M20	19300061250
2M20	H6B-SF-1L-2M20	19300061290
M25	H6B-SF-1L-M25	19300061350
2M25	H6B-SF-1L-2M25	19300061390
PG16	H6B-SF-1L-PG16	09300061251
2PG16	H6B-SF-1L-2PG16	09300061291
	带塑料盖 With plastic cover	
M20	H6B-SF-1L-CV-M20	19300061255
2M20	H6B-SF-1L-CV-2M20	19300061295
M25	H6B-SF-1L-CV-M25	19300061355
2M25	H6B-SF-1L-CV-2M25	19300061395
PG16	H6B-SF-1L-CV-PG16	09300061256
2PG16	H6B-SF-1L-CV-2PG16	09300061296
	带金属盖 With metal cover	
M20	H6B-SF-1L-MCV-M20	19300062255
2M20	H6B-SF-1L-MCV-2M20	19300062295
M25	H6B-SF-1L-MCV-M25	19300062355
2M25	H6B-SF-1L-MCV-2M25	19300062395
PG16	H6B-SF-1L-MCV-PG16	09300062256
2PG16	H6B-SF-1L-MCV-2PG16	09300062296

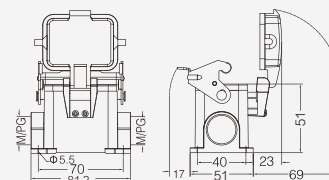

封底下壳 高结构 Housings, surface mounting, high construction

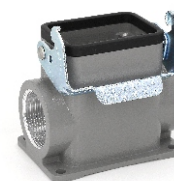

螺纹 Thread	型号 Type	订货号 Part Number
M25	H6B-SFH-1L-M25	19300060251
2M25	H6B-SFH-1L-2M25	19300060291
M32	H6B-SFH-1L-M32	19300060252
2M32	H6B-SFH-1L-2M32	19300060292
PG21	H6B-SFH-1L-PG21	09300060252
2PG21	H6B-SFH-1L-2PG21	09300060292
PG29	H6B-SFH-1L-PG29	09300060253
2PG29	H6B-SFH-1L-2PG29	09300060293
	带塑料盖 With plastic cover	
M25	H6B-SFH-1L-CV-M25	19300060256
2M25	H6B-SFH-1L-CV-2M25	19300060296
M32	H6B-SFH-1L-CV-M32	19300060257
2M32	H6B-SFH-1L-CV-2M32	19300060297
PG21	H6B-SFH-1L-CV-PG21	09300060257
2PG21	H6B-SFH-1L-CV-2PG21	09300060297
PG29	H6B-SFH-1L-CV-PG29	09300060258
2PG29	H6B-SFH-1L-CV-2PG29	09300060298
	带金属盖 With metal cover	
M25	H6B-SFH-1L-MCV-M25	19300067256
2M25	H6B-SFH-1L-MCV-2M25	19300067296
M32	H6B-SFH-1L-MCV-M32	19300061257
2M32	H6B-SFH-1L-MCV-2M32	19300061297
PG21	H6B-SFH-1L-MCV-PG21	09300062257
2PG21	H6B-SFH-1L-MCV-2PG21	09300062297
PG29	H6B-SFH-1L-MCV-PG29	09300062258
2PG29	H6B-SFH-1L-MCV-2PG29	09300062298

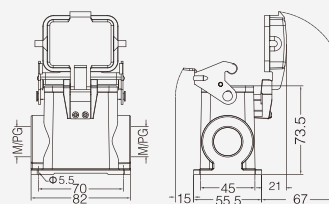

## 6B 金属外壳 Metal Hoods & Housings

防护等级 Degree of protection : IP65

防护盖 Protection covers, plastic



接线方式 Connect way	描述 Applications	型号 Type	订货号 Part Number
---	塑料盖 For hoods	H6B-CV-2C	09300065420

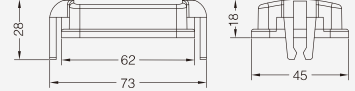

防护盖 Protection covers, metal



接线方式 Connect way	描述 Applications	型号 Type	订货号 Part Number
	金属盖/用于上壳 For hoods	H6B-MCV-2B/1	09300065427
	金属盖/用于下壳 For housings	H6B-MCV-2B/2	09300065425

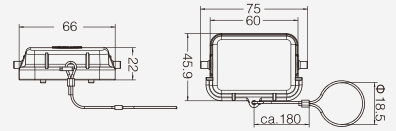

防护盖 Protection covers, metal



接线方式 Connect way	描述 Applications	型号 Type	订货号 Part Number
	金属盖/用于上壳 For hoods	H6B-MCV-1L.1S	09300065423

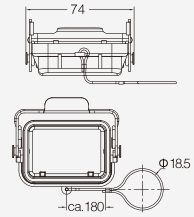

上壳侧出线/顶出线 高结构 Hoods,side&top entry,high construction



型号为:H6B-SEH/TEH-2B-XX/XX  
如有需要请与我司联系



6B 金属外壳 适用于苛刻环境(耐腐蚀) Metal Hoods & Housings For higher environmental requirements

防护等级 Degree of protection : IP65

上壳 侧出线 Hoods, side entry



螺纹 Thread	型号 Type	订货号 Part Number
M20	H6B-MSE-2B-M20	19370061540
PG13.5	H6B-MSE-2B-PG13.5	09370061540

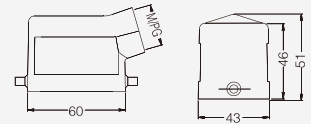

上壳 侧出线 高结构 Hoods, side entry, high construction



螺纹 Thread	型号 Type	订货号 Part Number
M25	H6B-MSEH-2B-M25	19370060546
PG21	H6B-MSEH-2B-PG21	09370060542

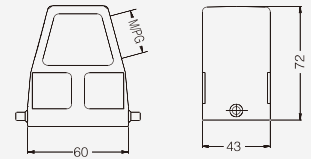

上壳 顶出线 Hoods, top entry



螺纹 Thread	型号 Type	订货号 Part Number
M20	H6B-MTE-2B-M20	19370061440
PG13.5	H6B-MTE-2B-PG13.5	09370061440
PG16	H6B-MTE-2B-PG16	09370061441

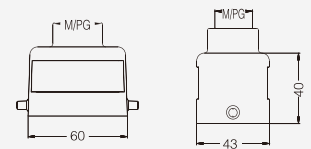

上壳 顶出线 高结构 Hoods, top entry, high construction



螺纹 Thread	型号 Type	订货号 Part Number
M25	H6B-MTEH-2B-M25	19370060446

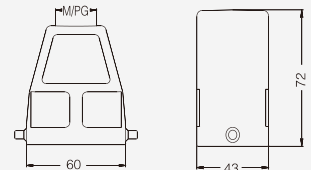

飞线下壳 Housings, cable to cable



螺纹 Thread	型号 Type	订货号 Part Number
PG13.5	H6B-MCCT-1L-PG13.5	09370061750

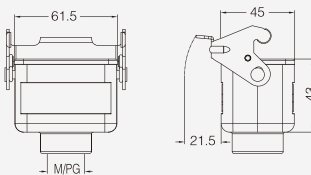

## 6B 金属外壳 适用于苛刻环境(耐腐蚀) Metal Hoods & Housings For higher environmental requirements

防护等级 Degree of protection : IP65

上壳 侧出线 Hoods, side entry



螺纹 Thread	型号 Type	订货号 Part Number
---	H6B-MBK-1L	09370060301
	带金属盖 With metal cover	
---	H6B-MBK-1L-MMCV	09370060318

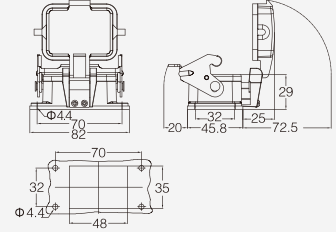

封底下壳 Housings, surface mounting



螺纹 Thread	型号 Type	订货号 Part Number
2PG16	H6B-MSF-1L-2PG16	09370061291
2M20	H6B-MSF-1L-2M20	19370061290

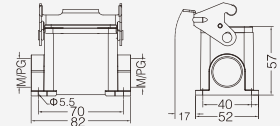

防护盖 Protection covers



螺纹 Thread	型号 Type	订货号 Part Number
M25	H6B-MMCV-2B/1	09370065407
	H6B-MMCV-2B/2	09370065405

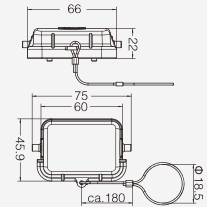



## 6B 高防护外壳 Hoods & Housings for harsh environmental requirements

防护等级 Degree of protection : IP68

W version

上壳 侧出线 高结构 Hoods, side entry, high construction



螺纹 Thread	型号 Type	订货号 Part Number
M20	HP6B-SEH-2S-M20	19400060210
M25	HP6B-SEH-2S-M25	19400060211
M32	HP6B-SEH-2S-M32	19400060212
PG16	HP6B-SEH-2S-PG16	09400060211
PG21	HP6B-SEH-2S-PG21	09400060212

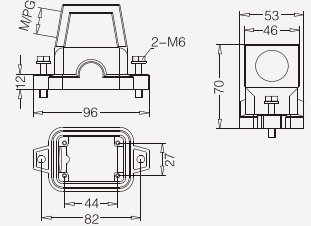

上壳 顶出线 高结构 Hoods, top entry, high construction



螺纹 Thread	型号 Type	订货号 Part Number
M20	HP6B-TEH-2S-M20	19400060220
M25	HP6B-TEH-2S-M25	19400060221
M32	HP6B-TEH-2S-M32	19400060222
PG16	HP6B-TEH-2S-PG16	09400060221
PG21	HP6B-TEH-2S-PG21	09400060222
PG29	HP6B-TEH-2S-PG29	09400060223

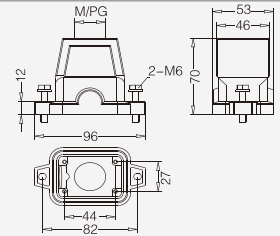

封底下壳 高结构 Housings, surface mounting, high construction



螺纹 Thread	型号 Type	订货号 Part Number
M20	HP6B-SFH-2H-M20	19400060230
M25	HP6B-SFH-2H-M25	19400060231
M32	HP6B-SFH-2H-M32	19400060232
PG16	HP6B-SFH-2H-PG16	09400060231
PG21	HP6B-SFH-2H-PG21	09400060232

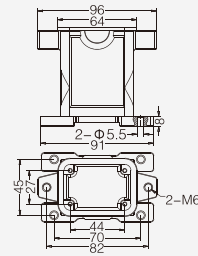

不封底下壳 Housings, bulkhead mounting



螺纹 Thread	型号 Type	订货号 Part Number
---	HP6B-BK-2H	09400060201

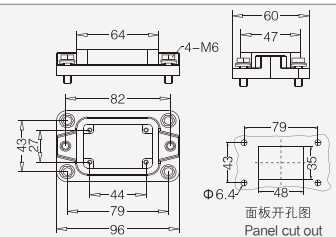

## 6B 高防护外壳 Hoods & Housings for harsh environmental requirements

防护等级 Degree of protection : IP68

H version

上壳 侧出线 高结构 Hoods, side entry, high construction



螺纹 Thread	型号 Type	订货号 Part Number
	螺栓联锁 Screw locking	
M20	HP6B/H-SEH-2S-M20	19400060510
M25	HP6B/H-SEH-2S-M25	19400060511
M32	HP6B/H-SEH-2S-M32	19400060512
PG16	HP6B/H-SEH-2S-PG16	09400060511
PG21	HP6B/H-SEH-2S-PG21	09400060512
PG29	HP6B/H-SEH-2S-PG29	09400060513
	轴销联锁 Toggle locking	
M20	HP6B/H-SEH-2T-M20	19400060500
M25	HP6B/H-SEH-2T-M25	19400060501
M32	HP6B/H-SEH-2T-M32	19400060502
PG16	HP6B/H-SEH-2T-PG16	09400060501
PG21	HP6B/H-SEH-2T-PG21	09400060502

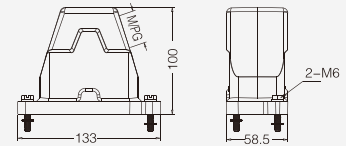

上壳 顶出线 高结构 Hoods, top entry, high construction



螺纹 Thread	型号 Type	订货号 Part Number
	螺栓联锁 Screw locking	
M20	HP6B/H-TEH-2S-M20	19400060410
M25	HP6B/H-TEH-2S-M25	19400060411
M32	HP6B/H-TEH-2S-M32	19400060412
PG16	HP6B/H-TEH-2S-PG16	09400060411
PG21	HP6B/H-TEH-2S-PG21	09400060412
PG29	HP6B/H-TEH-2S-PG29	09400060413
	轴销联锁 Toggle locking	
M20	HP6B/H-TEH-2T-M20	19400060400
M25	HP6B/H-TEH-2T-M25	19400060401
M32	HP6B/H-TEH-2T-M32	19400060402
PG16	HP6B/H-TEH-2T-PG16	09400060401
PG21	HP6B/H-TEH-2T-PG21	09400060402
PG29	HP6B/H-TEH-2T-PG29	09400060403

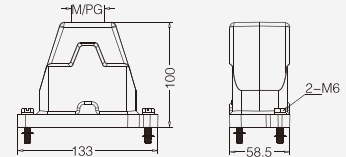

封底下壳 高结构 Housings, surface mounting, high construction



螺纹 Thread	型号 Type	订货号 Part Number
	螺栓联锁 Screw locking	
M20	HP6B/H-SFH-2H-M20	19400061260
M25	HP6B/H-SFH-2H-M25	19400061261
M32	HP6B/H-SFH-2H-M32	19400061262
PG16	HP6B/H-SFH-2H-PG16	09400061260
PG21	HP6B/H-SFH-2H-PG21	09400061261
PG29	HP6B/H-SFH-2H-PG29	09400061262
	轴销联锁 Toggle locking	
M20	HP6B/H-SFH-2T-M20	19400061270
M25	HP6B/H-SFH-2T-M25	19400061271
M32	HP6B/H-SFH-2T-M32	19400061272
PG16	HP6B/H-SFH-2T-PG16	09400061270
PG21	HP6B/H-SFH-2T-PG21	09400061271
PG29	HP6B/H-SFH-2T-PG29	09400061272

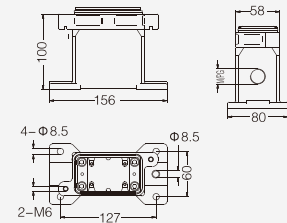





6B 高防护外壳 Hoods & Housings for harsh environmental requirements

防护等级 Degree of protection : IP68

H version

不封底外壳 Housings, bulkhead mounting



螺纹 Thread	型号 Type	订货号 Part Number
---	螺栓联锁 Screw locking HP6B/H-BK-2H	09400060311
---	轴销联锁 Toggle locking HP6B/H-BK-2T	09400060301
---	带金属盖 With metal cover 螺栓联锁 Screw locking HP6B/H-BK-2H-MCV	09400060317
---	轴销联锁 Toggle locking HP6B/H-BK-2T-MCV	09400060307

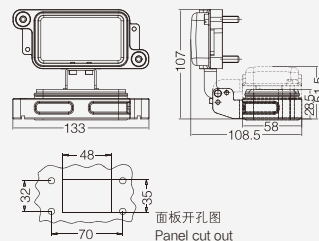

防护盖 Protection covers



螺纹 Thread	型号 Type	订货号 Part Number
---	螺栓联锁 Screw locking HP6B/H-MCV-2S	09400065411
---	轴销联锁 Toggle locking HP6B/H-MCV-2T	09400065401

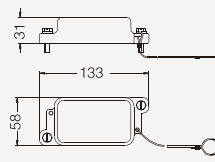

上壳 侧出线 高结构 Hoods, side entry, high construction

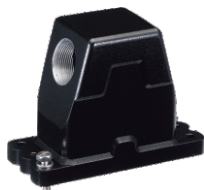

螺纹 Thread	型号 Type	订货号 Part Number
M20	HP6B/H-SEH-4S-M20	19400061360
M25	HP6B/H-SEH-4S-M25	19400061361
M32	HP6B/H-SEH-4S-M32	19400061362
M40	HP6B/H-SEH-4S-M40	19400061363
PG16	HP6B/H-SEH-4S-PG16	09400061361
PG21	HP6B/H-SEH-4S-PG21	09400061362

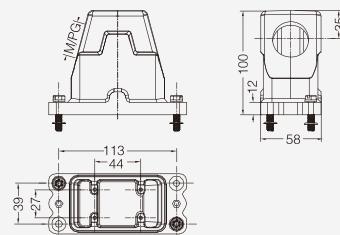

上壳 顶出线 高结构 Hoods, top entry, high construction

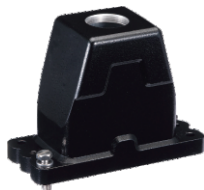

螺纹 Thread	型号 Type	订货号 Part Number
M20	HP6B/H-TEH-4S-M20	19400061460
M25	HP6B/H-TEH-4S-M25	19400061461
M32	HP6B/H-TEH-4S-M32	19400061462
M40	HP6B/H-TEH-4S-M40	19400061463
PG16	HP6B/H-TEH-4S-PG16	09400061461
PG21	HP6B/H-TEH-4S-PG21	09400061462
PG29	HP6B/H-TEH-4S-PG29	09400061463

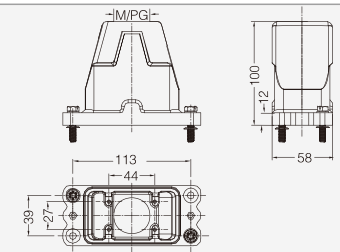

不封底外壳 Housings, bulkhead mounting



螺纹 Thread	型号 Type	订货号 Part Number
---	HP6B/H-BK-4H	09400060202

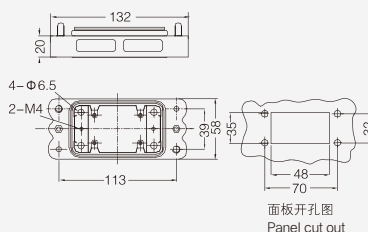

## 6B 高防护外壳 Hoods & Housings for harsh environmental requirements

### 防护等级 Degree of protection : IP68

#### 上壳 侧出线 高结构 Hoods, side entry, high construction



螺纹 Thread	型号 Type	订货号 Part Number
M20	HC6B-SEH-2S-M20	19400061500
M25	HC6B-SEH-2S-M25	19400061501
PG16	HC6B-SEH-2S-PG16	09400061500
PG21	HC6B-SEH-2S-PG21	09400061501

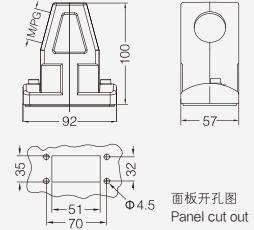

#### 上壳 顶出线 高结构 Hoods, top entry, high construction



螺纹 Thread	型号 Type	订货号 Part Number
M20	HC6B-TEH-2S-M20	19400061550
M25	HC6B-TEH-2S-M25	19400061551
PG16	HC6B-TEH-2S-PG16	09400061550
PG21	HC6B-TEH-2S-PG21	09400061551

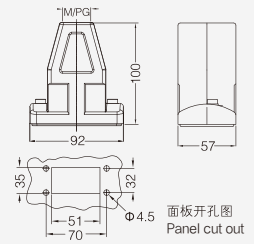

#### 芯体安装支块 Protection covers



描述 Application	型号 Type	订货号 Part Number
整体型外壳适配 For integral type hoods	APT-C	09400061600

